



**Industrial Factories  
Commercial Buildings  
Residences, Villas  
Mixed-use Buildings**



# Economic, accurate and reliable business.

We provide professional contracting services for industrial factories, commercial buildings, residential complexes, villas, and mixed-use developments, covering all stages from project design to ground improvement, excavation, structural and architectural construction, turnkey project delivery, and commissioning—primarily in Bursa, across Turkey, and in international markets.

With 23 years of experience in 8 countries, our ability to work in different cultural environments, along with our industry expertise and international experience, allow us to provide economical, accurate and reliable solution.

We look forward to collaborating with you as both the main contractor and subcontractor on your construction and building projects.



**Industrial  
Factories**



**Commercial  
Buildings**



**Residences,  
Villas**



**Mixed-use  
Buildings**

## 23 Years in 8 Countries...

With our ability to work across different cultures, sectoral expertise, and international experience, we deliver economical, accurate, and reliable solutions.



Afghanistan  
Azerbaijan  
S.Africa  
Iraq  
Romania  
S.Arabia  
Türkiye  
Turkmenistan



## Founder Kenan Doğan

He possesses a resilient and determined spirit that has propelled both his educational and professional endeavors forward.

### **Until 2005;**

He had been actively involved in hospital and prefabric construction in Yalova, Earthquake housing, business centers, and road-infrastructure in Gölcük, Düzce and Kaynaşlı, School and business center in Bingöl, Hospital in Hizan, Bitlis, BTC oil pipeline pumping station in Sivas, various project construction sites.

### **Between 2005 and 2018;**

He worked in Afghanistan, Iraq, Romania, Azerbaijan, Turkmenistan, Saudi Arabia, and South Africa for 13 years on large-scale projects.

### **In the interim periods;**

He had experience in Solar Power Plant installation works in the Erzurum region. He had experience in Solid Waste Storage Facility works in Gaziantep, Kütahya Emet, and TRNC Nicosia regions.

### **Between 2018 and 2020;**

He continued his business life with DownTown mixed life project in Bursa.

### **Towards the end of 2020;**

He decided to continue his business life commercially and established “İŞBÜKEN YAPI İNŞAAT SAN. TİC. LTD. ŞTİ” on 12.11.2020. He has a Bachelor’s degree in Civil Engineering and speaks English, Farsi, and Romanian.

He has the necessary technical proficiency and has received the necessary training in Operational and Systems Engineering, CAD programs, ISO 9001 Quality Management, Internal Auditor, ISO 14001 Environmental Management, OHSAS 18001 Occupational Health and Safety.

Integrated Management, Teamwork and Management Skills. He had experience in project design and implementation, super-exposure, as-built, quantity surveying, earthworks, infrastructure, roads, hard landscaping, rough and finishing works to the finest details, and has taken active responsibility in all work items.

He has a self-developed, challenging, self-sacrificing, stable, open to innovation, reliable, and honest personality.

# Pre-Company Professional Life

## 2,5 years - ATIS YAPI CONSTRUCTION

### HOUSING, HOTEL, SHOPPING, LIFE AND ENTERTAINMENT CENTER PROJECTS

DOWNTOWN prj. / 9 hectares of floor area, 600.000m<sup>2</sup> construction area, 61.000m<sup>2</sup> green and social area, 71.000m<sup>2</sup> Shopping Center, 13 units. It includes 1,008 flats consisting of high-rise blocks, 4,000 car parking garages, school, dormitory and mosque constructions. FSM BULVAR, WESTPOINT, MAVIDEN CITY, MEVSİM MUDANYA, ARYA MUDANYA Its projects are housing projects in different locations, different sizes and features.

## 8 years - TEPE CONSTRUCTION

### TURKMENISTAN : PROJECT OF 8 GRAIN STORAGE AND PROCESSING INDUSTRIAL PLANTS

Grain storage and processing plants were built in 8 different provinces in 4 different states in Turkmenistan. Each one was built on a terrain of 50.000 square meters, totaling 400.000 square meters and has a capacity of 360 thousand tons. Each plant has a construction site of 124.000 square meters (steel assembly on base), a road area of 126.000 square meters, 17.000 square meters of infrastructure and 150.000 squaremeters of green field.

### IRAQ : NEW SULAYMANIYAH UNIVERSITY CAMPUS PROJECT

The project was built on a construction site of 363.000 square meters on a terrain of 190 hectares and includes 156.000 square meters of hard landscape area, 64.000 square meters of infrastructure length, outdoor and indoor sports fields and earth movements, landscaping works and some additional works.

### AFGHANISTAN : AIRPORT REGION, ISAF MILITARY CAMP PROJECT

It includes camp buildings, heliports, concrete roads, infrastructure works and landscaping works on a terrain of 443.394 square meters Along with topographic works, organization of earthwork operations, following up machinery and equipment works and delivery of works to supervision companies were conducted.

### SİVAS / Turkey : BTC OIL PIPELINE, SİVAS PT4 PUMPING STATION PROJECT

I have gained significant experience in this project composed of 50% mechanical and steel construction which necessitated a very sensitive workmanship and surveying work.

## 2 years - YENİĞÜN CONSTRUCTION

### SAUDI ARABIA / KHURAI: SAUDI F-15 FLEET MODERNIZATION PROGRAM, (RSAF) KHURAI ELECTRONIC WARFARE RANGE

Tutor Perini Within 70.000 hectares of land, 110 km embankment, 92 km stabilized road, 50.000 m<sup>2</sup> stabilized runway, 40.000 m<sup>2</sup> asphalt, 700.000 m<sup>3</sup> excavation / fill, 50.000 m<sup>2</sup> construction area, 14 different points (10.000 barrels, 1100 containers, 4500 vehicle tires) Includes current jobs.

### SAUDI ARABIA/JEDDAH JEDDAH AIRPORT AIRCRAFT MAINTENANCE HANGARS PROJECT

It was built by TAV Construction and includes 140.00 tons of plant mix base, 150.000 tons of hot mix and 50.000 tons of asphalt works on a floor area of 300.000 square meters in a land of 90 hectares.

## 2 years - OZER CONSTRUCTION

### ROMANIA : REAL ESTATE DEVELOPMENT PROJECT (Bellevue Sinaia Housing)

ROMANIA : GAYRİMENKUL GELİSTİRME PROJESİ ( Bellevue Sinaia Konut ) Bored pile was implemented due to steep land. 30.000 square meters of indoor space, parking lot and parking garage, swimming pool and indoor sports hall along with some infrastructure works were completed.

# Pre-Company Professional Life

(1 year)

## **AFGHANISTAN / YUKSEL CONSTRUCTION : AMERICAN BASE (AIRPORT) APRON PROJECT**

I was contractually appointed on a project basis to American Base (Airport) Apron Project; topographic works of concrete pavement of apron area of 110.000 square meters, including sub-bases.

## **AZERBAIJAN / MAKYOL-AZER CONSTRUCTION : BAKU BELTWAY PROJECT**

I was appointed to Baku Beltway Project towards its completion; it includes 21 kilometers of main road and 11 kilometers of byways.

**3,5 years - BERIL CONSTRUCTION**

## **DÜZCE, GÖLCÜK, YALOVA, BİNGÖL, BİTLİS, KAYNAŞLI / TÜRKİYE : "BERİL HARİTA"**

I have worked for 3.5 (three and a half) years within this mapping company for the below projects.

- 1) YENİGUN CONST./CONST. of DÜZCE PERMANENT EARTHQUAKE HOUSING / ROAD AND INF.
- 2) OYAK CONST./ CONSTRUCTION of GÖLCÜK BUSINESS CENTERS.
- 3) MERCAN CONST./ CONSTRUCTION of YALOVA THERMAL SII HOSPITAL.
- 4) GİRİSİMCİLER CONST./ CONSTRUCTION of BİNGÖL SCHOOL AND BUSINESS CENTER.
- 5) MERCAN CONST./ CONSTRUCTION of BİTLİS HİZAN STATE HOSPITAL
- 6) BARMEK CONST./ CONSTRUCTION of KAYNASLI PERMANENT EARTHQUAKE HOUSING ROADS.

**1 year - OZYAPICILAR CONSTRUCTION**

## **GOLCUK / TURKEY: PREFABRICATED AND PERMANENT EARTHQUAKE HOUSING PROJECT**

Within the scope of road and infrastructure construction.

## **SPP and Waste Facility**

Solar Power Plant installation works in Erzurum region, Solid Waste Storage Facility works in Gaziantep, KütahyaEmet, TRNC Nicosia regions.



**Economic, accurate  
and reliable business.**

# A good company means economical and high-quality manufacturing.

"İşbüken Yapı İnşaat" aims to be the preferred brand in the sector with 23 years of work experience in 8 countries, adopting reliability and honesty, doing its job well, with the desire to continuously raise its reputation and being respected.

"İşbüken Yapı İnşaat" knows very well what wrong and sloppy manufacturing, irregular work and delays cost. The organization is cognizant that success is assured through a combination of willingness, attentiveness, innovation, efficiency, creativity, and meticulous work.

**23**  
years of  
experience



## Safe projects build secure tomorrows.

It values knowledge and technology, aims to complete the tasks it undertakes, and has the structure to elevate quality and customer satisfaction to the highest level thanks to its experience.

"İşbüken Yapı İnşaat" has adopted the business principles expressed by Sezai Türkeş and Fevzi Akkaya, who are deemed among pioneers of the sector.

("The concrete you pour should be beautiful even if it remains under the ground". Aim for the best outcome, even if no one else praises it, even if no one else sees it. The degree to which you do your job well is a reflection of your character, not money).

# Fields Of Activity

## Industrial Factory

Industrial construction projects encompass the construction or renovation of large-scale facilities such as factories, storage facilities, industrial complexes, power plants, refineries, and petrochemical plants. Designed to meet specialized requirements and featuring high technical complexity, these structures are built with durable materials and executed under the leadership of high-quality craftsmanship to ensure economic, precise, and reliable solutions.

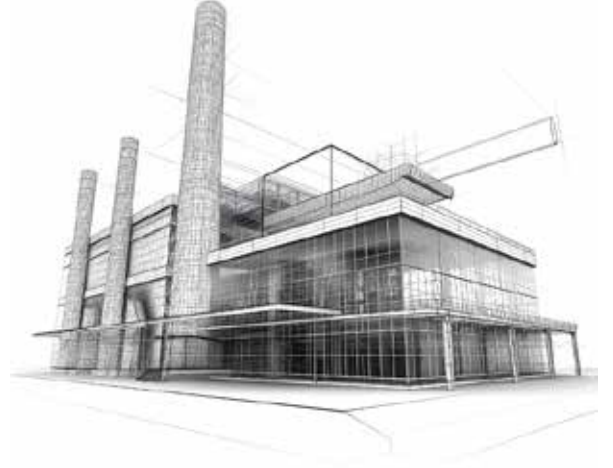

## Commercial Projects

Commercial construction projects include structures used for business purposes, such as business centers, office buildings, shopping malls, hotels, restaurants, and entertainment facilities. We focus on planning solutions that enhance customer experience, support business objectives, and facilitate operational processes while ensuring the efficient functioning of complex technical infrastructure systems.



## Residential & Villa

Residential projects include various types of buildings such as apartments, housing complexes, detached houses, and villas, each with different sizes and features. We prioritize comfort, aesthetics, visual appeal, functionality, efficient interior layouts, natural lighting, and green spaces to ensure a high-quality living experience.



## Mixed-use Buildings

We build the structures of the future through integrated projects that address all the needs of modern urban life. Mixed-use developments combine residential, office, retail, social, and cultural spaces within a single project, aligning with the dynamic nature of modern city living. In these projects, we offer solutions that not only meet individual needs but also add value to the broader social fabric.



# Projects



## Ay Bilgiç Oil Mill Facility

The facility consists of a single-story reinforced concrete and prefabricated structure with a total enclosed area of 3,000 m<sup>2</sup> on a 2,000 m<sup>2</sup> footprint. As the main contractor, we are responsible for the turnkey execution of all project phases.

Location  
**Bursa/Gemlik/  
Muratoba**

Employer  
**Ay Bilgiç**

Start/End Date  
**2024/2024**

Project Area  
**3.000 m2**



## Murat Özer Pinar Yumlu Residential Project

The project consists of a single block, 8 story reinforced concrete structure built on a 1,200 m<sup>2</sup> land area, with a total construction area of 10,000 m<sup>2</sup>. As the subcontractor for structural works, we are providing our expertise in this project.

Location  
**Bursa/Osmangazi/  
Hüdavengir**

Employer  
**Murat Özer  
İnşaat**

Start/End Date  
**2024/2025**

Project Area  
**10.000 m2**



## Karadeniz İskele Factory Project 2

The project consists of a single-block factory designed on a 2,000 m<sup>2</sup> land area, featuring a 3,500 m<sup>2</sup> enclosed space. It includes both reinforced concrete structures and prefabricated components. As the subcontractor for structural works, our scope of work includes: Continuous foundations and 28 socket foundations, Tie beams, Elevator shafts, Staircases, Helipad area and floor slabs, Retaining walls, Water tank

Location  
**Bursa/Nilüfer/  
Kayapa Sanayi**

Employer  
**Karadeniz  
İskele**

Start/End Date  
**2024/2024**

Project Area  
**8.500 m2**



## 145 Nolu S.S. Gemlik Treyler Cooperative Administrative Building

(Project planning completed)

In the project that we undertake as a contracting company, our services encompass all work items, ranging from the preparation of architectural designs to obtaining the necessary licenses.

Location  
**Bursa/Gemlik**

Employer  
**145 Nolu S.S.  
Gemlik Treyler  
Kooperatifi**

Start/End Date  
**2022/2024**

# Projects



## Burkon Mobilya Factory Project

The project entails a 4-storey reinforced concrete building, covering a closed area of 3,900 m<sup>2</sup> on a floor area of 1,378 m<sup>2</sup>. This includes a 3,667 m<sup>2</sup> factory space and a 234 m<sup>2</sup> administrative building. The project features varying floor heights, including floors reaching up to 7 meters in height. As the main contractor overseeing the project, all turnkey work items are comprehensively managed within the scope of our services.

Location	Employer	Start/End Date	Project Area
<b>Bursa/Nilüfer/ Görükle Sanayi</b>	<b>Burkon Mobilya</b>	<b>2023/2025</b>	<b>3.900 m<sup>2</sup></b>



## Safiye Solgun Housing Project

The project entails a 3-storey detached residential building, featuring a closed area of 395 m<sup>2</sup>, situated on a land area of 215 m<sup>2</sup>, with a living space of 80 m<sup>2</sup>. In the project that we undertake as a contracting company, our services encompass all work items, ranging from the preparation of architectural designs to obtaining the necessary licenses.

Location	Employer	Start/End Date	Project Area
<b>Bursa/Osmangazi/ Hamitler</b>	<b>Safiye Solgun</b>	<b>2023/2023</b>	<b>395 m<sup>2</sup></b>



## Işıksoy Textile Factory Project

The project comprises two adjacent warehouse blocks, designed as a reinforced concrete building, with a floor area of 3,255 m<sup>2</sup> and a closed area of 7,280 m<sup>2</sup>, situated on a land area of 5,440 m<sup>2</sup>, and it includes prefabricated constructions. The structure, composed of 42 sockets on a continuous foundation, incorporates earthquake walls and slabs reaching heights of up to 9.5 meters. Bored pile girder beam, Permanent foundation and socket, Foundation bond beam, Columns and earthquake walls, Slabs and intermediate beams (h=9,00 mt), Stairs, Garden Wall

Location	Employer	Start/End Date	Project Area
<b>Bursa/Osmangazi/ Ovaakça</b>	<b>Işıksoy Tekstil</b>	<b>2023/2023</b>	<b>7.280 m<sup>2</sup></b>



## Cemil Sevinç Factory Project

(Project planning completed)

The project involves a closed area of 2,246 m<sup>2</sup> on a land area of 2,130 m<sup>2</sup>, incorporating prefabricated fabrications within the scope of the factory and administrative building project. In the project that we undertake as a contracting company, all work items are comprehensively covered by our services.

Location	Employer	Start/End Date	Project Area
<b>Bursa/Nilüfer/ Kayapa OSB</b>	<b>Cemil Sevinç</b>	<b>2023/2023</b>	<b>2.246 m<sup>2</sup></b>

# Projects



## Fahrettin Yildirim Housing Project

The project encompasses a single-block reinforced concrete building, featuring a parking lot floor, a 6-meter high shop, and 10 standard floors, all situated on a 741 m2 land area. In the project where we are engaged as a subcontractor for the rough works, the construction area encompasses 7,440 m2.

Location	Employer	Start/End Date	Project Area
<b>Bursa/Nilüfer/ 23 Nisan</b>	<b>EC Proje Mimarlık Mühendislik</b>	<b>2022/2023</b>	<b>7.440 m2</b>



## Referans Elit Project

The project comprises a parking lot floor spanning a floor area of 3,500 m2, a single-block, 18-storey reinforced concrete building situated on 980 m2, a 115 m2 single-storey social facility, and a 100 m2 pool in the site garden. In the project where we operated with a tower crane, steel formwork was employed for columns and curtains, while scaffolding, H20, and wooden formwork were utilized in the construction of floors. In the project where we are engaged as a subcontractor for the rough works, the construction area encompasses 30,000 m2.

Location	Employer	Start/End Date	Project Area
<b>Bursa/Nilüfer/ 23 Nisan</b>	<b>Referans Yapı Murat Demir</b>	<b>2022/2023</b>	<b>30.000 m2</b>



## Tevfik Alkaya Housing Project

The project is a single-block reinforced concrete structure erected on a land area of 1,439 m2, encompassing 5 floors. In the project where we are engaged as a subcontractor for the rough works, the construction area encompasses 3,875 m2 in total.

Location	Employer	Start/End Date	Project Area
<b>Bursa/Osmangazi/ Hamitler</b>	<b>Konum Dekor Yapı</b>	<b>2023/2023</b>	<b>3.875 m2</b>



## Karadeniz İşkele Factory Project 1

The project encompasses a single-block factory, designed as a reinforced concrete building with a closed area of 2,100 m2, situated on a land area of 2,575 m2, inclusive of prefabricated manufacturing facilities. The rough works constitute the scope of work assigned to our company in the project where we operate as a subcontractor; Permanent foundation and 22 sockets, Bond beams, Elevator curtains, Stairs, Helicopter field and floor concreting

Location	Employer	Start/End Date	Project Area
<b>Bursa/Nilüfer/ Kayapa İstiklal</b>	<b>Karadeniz İskele</b>	<b>2021/2022</b>	<b>2.575 m2</b>

# Projects



## Nilüfer Municipality Koza Library

The library, spanning two floors across a total area of 1,930 square meters, comprises 5 spacious quiet study halls, a computer room, workshop spaces for diverse activities, a dedicated reading and activity room for children, and a book cafe. As the contracting company for the project, we handled the rough construction works, and other turnkey components were collaboratively completed with our benefactor.

Location	Employer	Start/End Date	Project Area
<b>Bursa/Nilüfer/ Görükle</b>	<b>Nilüfer Belediyesi</b>	<b>2021/2023</b>	<b>1.930 m2</b>



## Referans Yapı Balkan Park Project

The project involves the construction of a single-block, 8-storey reinforced concrete building with a floor area of 740 m2. In the project where we are engaged as a subcontractor for the rough works, the construction area encompasses 10,000 m2.

Location	Employer	Start/End Date	Project Area
<b>Bursa/Nilüfer/ Balkan</b>	<b>Referans Yapı Murat Demir</b>	<b>2021/2022</b>	<b>10.000 m2</b>



## 10 Bed Integrated District Hospital

The project entails the construction of a 10-bed Integrated District Hospital building on a 13,323 m2 property, featuring a seating area of 1,051 m2 and a closed area of 3,143 m2. In the project where we operated as a subcontractor for the initial construction phase, we successfully completed the construction of 2000 m2 of foundations and retaining walls. However, the project faced an interruption as the contract between Soykar Group and the Ministry of Health was terminated.

Location	Employer	Start/End Date	Project Area
<b>Bursa/Nilüfer/ Harmancık</b>	<b>Soykar Grup T.C. Sağlık Bkn.</b>	<b>2021/2021</b>	<b>13.323 m2</b>



## Pool Projects

The project consists of 2 swimming pool projects in different locations, Özlüce and Doburca in Villa gardens.

Location	Employer	Start/End Date
<b>Bursa/Nilüfer ve Osmangazi</b>	<b>Mefa Arıtma</b>	<b>2021/2021</b>

# References

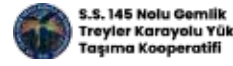

REFERANSYAPI



bozdemir





Üçevler Mah. İzmir Yolu Cad.  
No.241D/316 Nilüfer/Bursa/Türkiye  
+90 224 504 99 11  
+90 530 881 55 17

[info@isbuken.com.tr](mailto:info@isbuken.com.tr)  
[www.isbuken.com.tr](http://www.isbuken.com.tr)

